

DOMINO

Urinal Domino Sensor



DIMENSIONS

Length	430 mm
Width	315 mm
Height	665 mm

COLOURS AND OPTIONS



TECHNICAL DRAWINGS

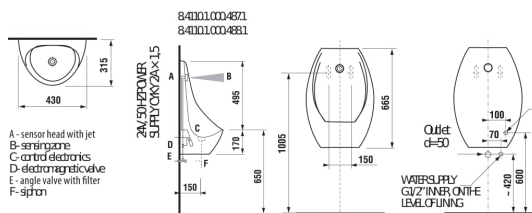

FEATURES

JIKA offers ceramic solutions geared towards the needs of the technical buildings. One of them is the Domino Sensor urinal with automatic flushing and a 24V infrared sensor. It is necessary to order a power supply for the urinal, which we offer for the installation of 1-5 and for 6-9 urinals. Among the benefits of the urinal are Antibac (glazed inner circuit and waste preventing dirt from adhering) and Rimless (construction without a flushing ring). Thanks to the absence of a flushing ring, dirt and bacteria do not settle in hard-to-reach places, making the urinal easier to maintain. We provide an extended warranty of 10 years for the urinal. We recommend using a concealed module for urinals.

Fixing kit: **Included**

Height (INCH): **26 3/16"**

Inlet diameter (inch): **1.57**

Inlet diameter (inch): **1 9/16"**

Inlet diameter (mm): **40**

Length (INCH): **16 15/16"**

Power supply (V): **24**

Remote control type: **Infrared**

Water inlet position: **Back horizontal**

Width (INCH): **12 3/8"**

COMPATIBLE WITH



Siphon
H890730000001

Siphon
H890732000001



Urinal partition, incl. installation kit
H44J601000###1



Urinal division, incl. installation kit
H847601###0001

Universal remote control
H894078000001



Power supply 24V DC for up to 9 sensors
H895072###0001



Power supply 24 V, DC for Golem, Livo a Domino urinals
H895091###0001



Urinal system
H893601000001



Domino

The JIKA brand assortment includes a range of high-quality ceramic products for building technical rooms, including the complete Domino urinal series.

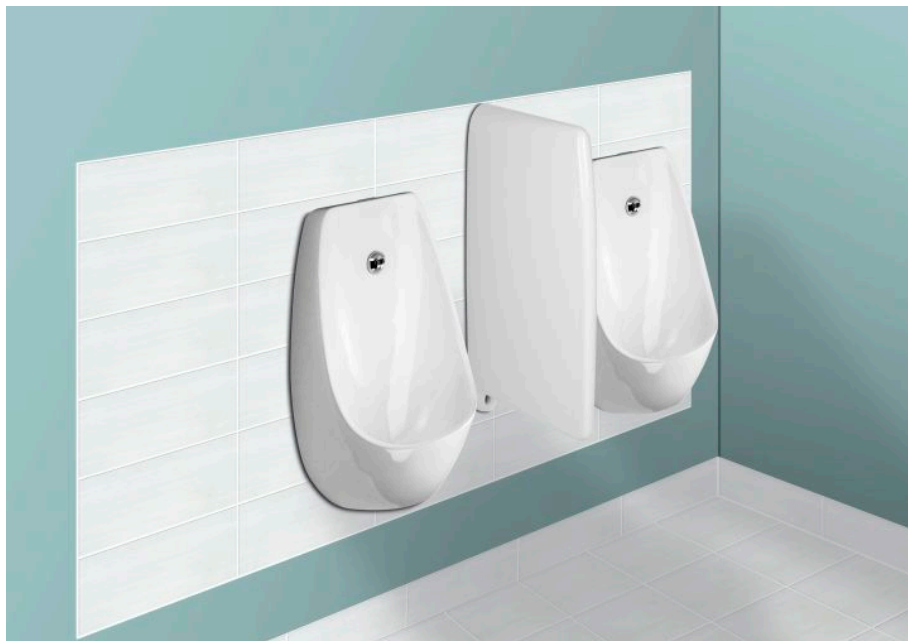

INSTALLATION AND USER MANUALS



[Installation Handbook](#)